

RCB0710P SERIES ~ Through Hole Power Inductors



RoHS Compliant

PART NUMBERING SYSTEM

RDR	0710P	—	150K	—	LF
TYPE	DIMENSIONS		INDUCTANCE		LEAD FREE

U : UL Tube
 P : PVC Tube

SHAPES AND DIMENSIONS

UNIT : mm

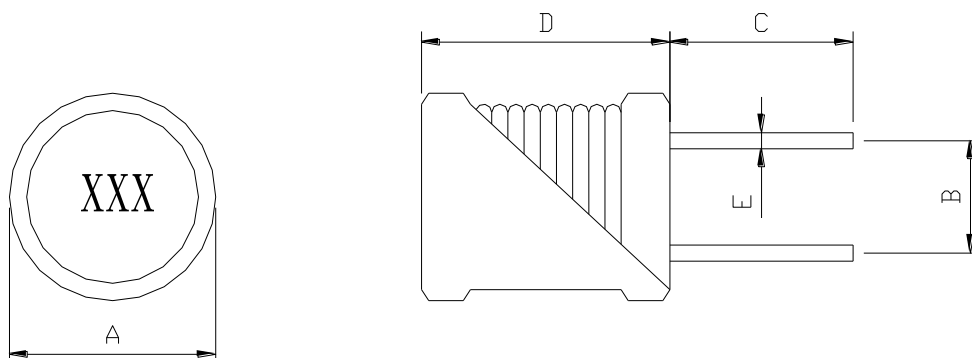

A=9.0 Max. B=5.0±0.5 C=10 Min. D=12.2 Max. E0.6 Ref.

STRUCTURAL DIAGRAM :

COMPONENT	MATERIALS
1.Core	Ferrite core
2.Wire	Polyurethane enameled copper wires
3.Lead wire	Tinned copper wires
4.Tube	Heat shrinkable tube, PVC or UL
5.Glue	Epoxy resin



RCB0710P SERIES ~ Through Hole Power Inductors



RoHS Compliant

SPECIFICATION TABLE

PART NUMBER	INDUCTANCE (μ H)	Q (min)	DCR (Ω) (max)	IDC (A) (max)	SRF(MHz) (min)	TEST FREQ. (f)
RCB0710P-1R0M-LF	1.0 \pm 20%	20	0.013	10	150	7.96MHz
RCB0710P-1R5M-LF	1.5 \pm 20%	20	0.016	8.5	130	7.96MHz
RCB0710P-2R2M-LF	2.2 \pm 20%	20	0.021	6.5	100	7.96MHz
RCB0710P-3R3M-LF	3.3 \pm 20%	20	0.025	5.5	79	7.96MHz
RCB0710P-4R7M-LF	4.7 \pm 20%	20	0.030	4.6	51	7.96MHz
RCB0710P-6R8M-LF	6.8 \pm 20%	20	0.035	4.1	29	7.96MHz
RCB0710P-100K-LF	10 \pm 10%	50	0.045	3.4	14	2.52MHz
RCB0710P-120K-LF	12 \pm 10%	50	0.050	3.1	13	2.52MHz
RCB0710P-150K-LF	15 \pm 10%	50	0.056	2.9	12	2.52MHz
RCB0710P-180K-LF	18 \pm 10%	40	0.061	2.66	11	2.52MHz
RCB0710P-220K-LF	22 \pm 10%	40	0.070	2.4	9.2	2.52MHz
RCB0710P-270K-LF	27 \pm 10%	40	0.080	2.22	8.5	2.52MHz
RCB0710P-330K-LF	33 \pm 10%	30	0.090	2.05	7.8	2.52MHz
RCB0710P-390K-LF	39 \pm 10%	30	0.10	1.85	6.9	2.52MHz
RCB0710P-470K-LF	47 \pm 10%	30	0.16	1.77	6.5	2.52MHz
RCB0710P-560K-LF	56 \pm 10%	30	0.18	1.48	5.4	2.52MHz
RCB0710P-680K-LF	68 \pm 10%	30	0.21	1.36	4.9	2.52MHz
RCB0710P-820K-LF	82 \pm 10%	30	0.23	1.30	4.1	2.52MHz
RCB0710P-101K-LF	100 \pm 10%	20	0.28	1.40	3.7	796KHz
RCB0710P-121K-LF	120 \pm 10%	20	0.32	1.25	3.4	796KHz
RCB0710P-151K-LF	150 \pm 10%	20	0.37	1.15	3.2	796KHz
RCB0710P-181K-LF	180 \pm 10%	20	0.58	1.08	2.8	796KHz
RCB0710P-221K-LF	220 \pm 10%	20	0.65	1.00	2.7	796KHz
RCB0710P-271K-LF	270 \pm 10%	20	0.75	0.90	2.4	796KHz

1. Current to cause 10% Max. inductance drop.
2. Operating temperature range -40°C to +85°C
3. Electrical specifications at 25°C



RCB0710P SERIES ~ Through Hole Power Inductors



RoHS Compliant

SPECIFICATION TABLE

PART NUMBER	INDUCTANCE (μ H)	Q (min)	DCR (Ω) (max)	IDC (A) (max)	SRF(MHz) (min)	TEST FREQ. (f)
RCB0710P-331K-LF	330 \pm 10%	20	0.85	0.78	2.3	796MHz
RCB0710P-391K-LF	390 \pm 10%	20	1.0	0.74	2.1	796MHz
RCB0710P-471K-LF	470 \pm 10%	20	1.1	0.68	1.9	796MHz
RCB0710P-561K-LF	560 \pm 10%	20	1.4	0.64	1.8	796MHz
RCB0710P-681K-LF	680 \pm 10%	20	1.6	0.59	1.6	796MHz
RCB0710P-821K-LF	820 \pm 10%	20	1.8	0.56	1.5	796MHz
RCB0710P-102K-LF	1000 \pm 10%	50	2.9	0.51	1.3	252MHz

1. Current to cause 10% Max. inductance drop.
2. Operating temperature range -40°C to +85°C
3. Electrical specifications at 25°C